

RIB Highway



The RIB Highway barrier is designed as a rapid opening barrier with foam rubber surrounded carbon-fibre boom, thus allowing violent impacts to be absorbed and minimal damage to be impacted.



The Highway barrier is designed with a 220v, 3-phase motor which is able to manage a high volume of traffic at highways toll stations and heavy-volume car parks.

The IP54 rating provides protection from limited dust ingress and protection from water spray from any direction, giving a safe and secure housing for the barriers mechanics and controls.



Technical Data

Maximum boom length	3 metres
Opening time	1 second
Power supply	230V
Operating Temperatures	-10°C to +55°C
Testing Cycles	5,000,000
Protection	IP54

- The RIB Highway barrier is designed to secure an opening of up to 3 metres
- In the event of a power failure, the barrier boom will raise automatically, without the requirement of personnel operation
- Balanced with one compression spring and tested to 5,000,000 cycles
- Complete control panel and inverter to maintain closed position of the boom and to manage the boom movement

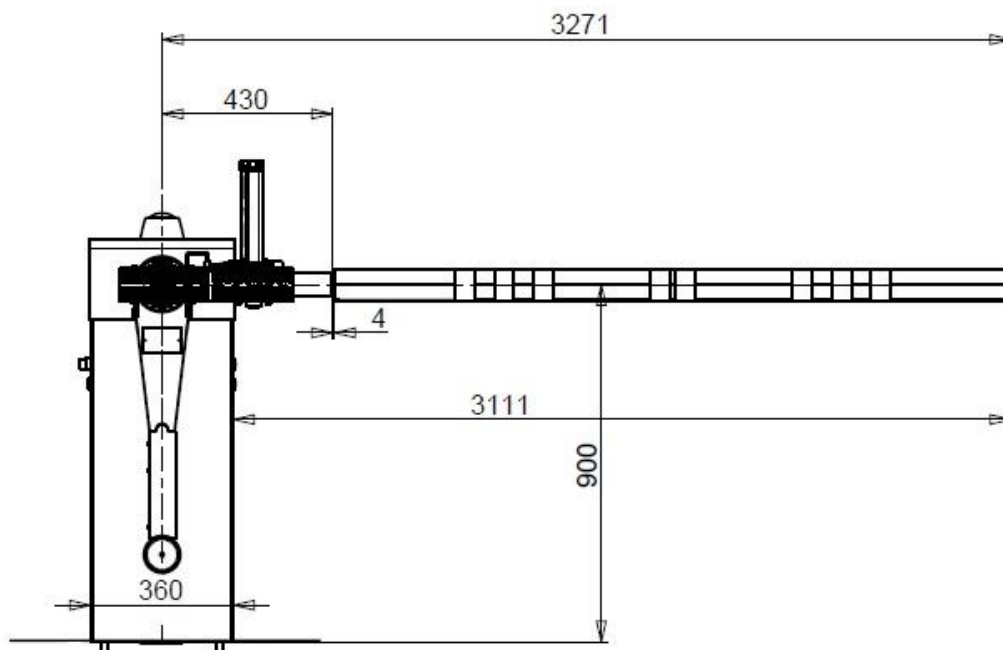

For more information about our RIB Highway barriers, please contact us on:

0800 169 8688 orsales@automatesystems.co.uk

